

Wooster High School

515 Oldman Road



From Cleveland
 Take I-71 South to St. Rt. 83 South (Burbank Exit). Take 83 South into Wooster. Just past Buehlers Market stay right and follow Burbank Rd. to stop sign. Take a right (Burbank) and proceed to the first stop light (Oldman Rd.). Turn right on Oldman Rd. The H.S. is approx. 1/4 mile on the right.

From Akron
 Take I-76 West to St. Rt. 21 South to St. Rt. 585 West into Wooster. Just past the Rubbermaid plant take 83 North signs (Wooster By-Pass) to the first stop light (Friendsville Rd.). Turn left on Friendsville (which becomes Burbank Rd.) At first stop light, turn right on Oldman Rd. The H.S. is approx. 1/4 mile on the right.

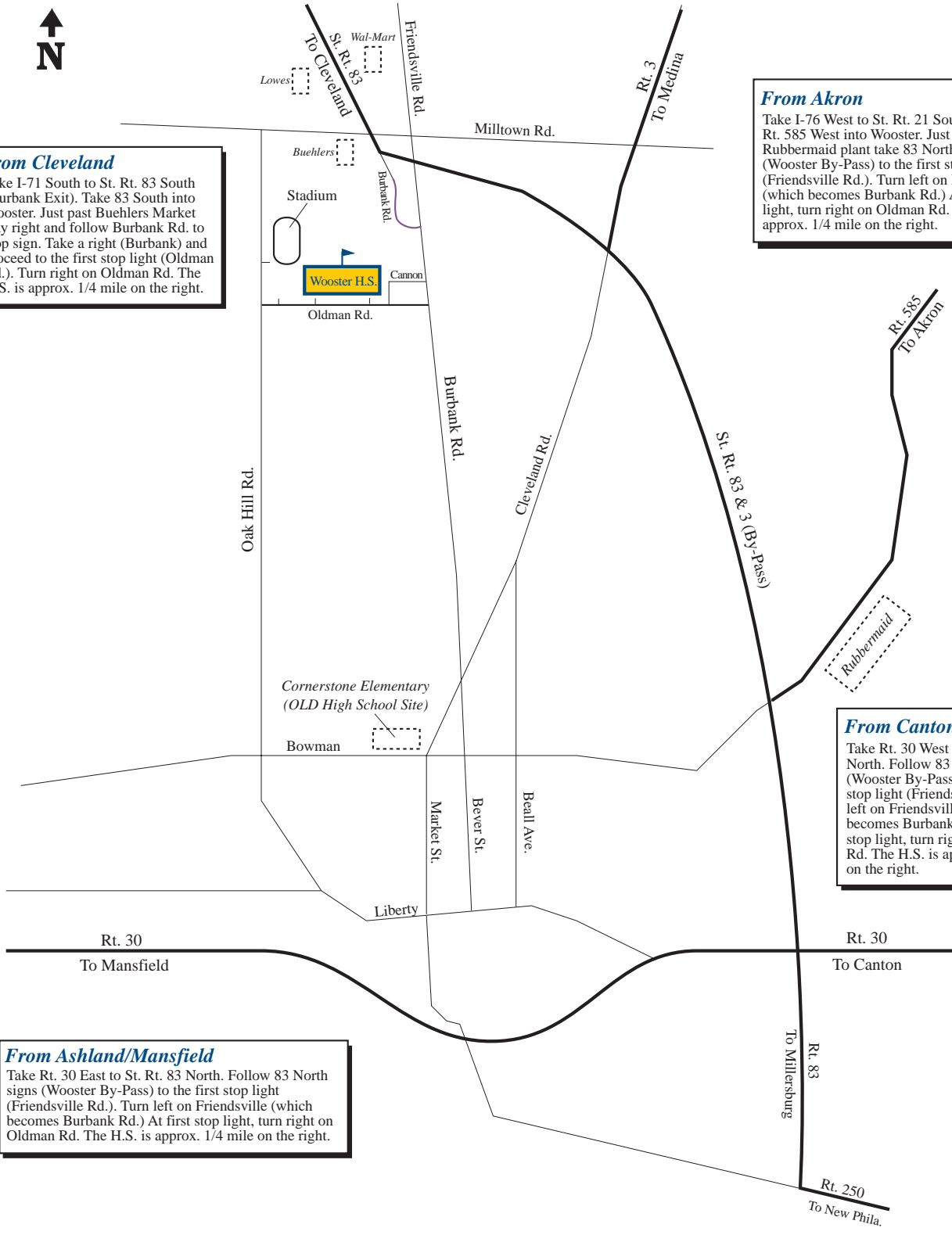

From Canton
 Take Rt. 30 West to St. Rt. 83 North. Follow 83 North signs (Wooster By-Pass) to the first stop light (Friendsville Rd.). Turn left on Friendsville (which becomes Burbank Rd.) At first stop light, turn right on Oldman Rd. The H.S. is approx. 1/4 mile on the right.

From Ashland/Mansfield
 Take Rt. 30 East to St. Rt. 83 North. Follow 83 North signs (Wooster By-Pass) to the first stop light (Friendsville Rd.). Turn left on Friendsville (which becomes Burbank Rd.) At first stop light, turn right on Oldman Rd. The H.S. is approx. 1/4 mile on the right.

From New Philadelphia
 Take St. Rt. 250 North. Just west of Guerne take St. Rt. 83 North signs (Wooster By-Pass) to the first stop light (Friendsville Rd.). Turn left on Friendsville (which becomes Burbank Rd.) At first stop light, turn right on Oldman Rd. The H.S. is approx. 1/4 mile on the right.